

File Name: P:\Projects\2023\237806 Blossman Gas Pompano\CAD Files Drawings\237806-C-DTL.dwg -- (Plotted by: Marcos Mendoza on Wednesday, May 14, 2025 12:04:35 PM)

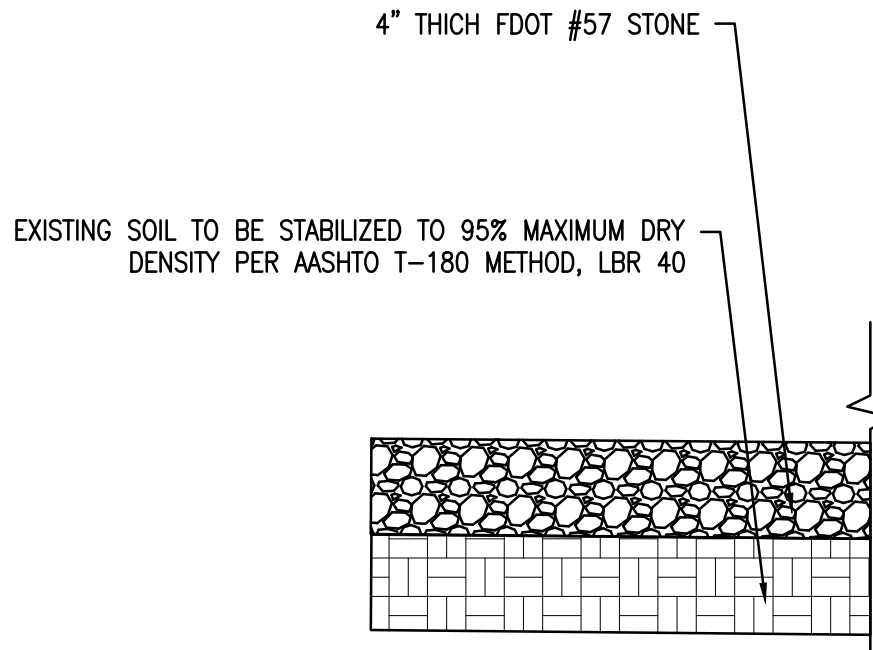

CRUSHED STONE AREA
SCALE: N.T.S. CURRENT

1 1/2" SUPERPAVE ASPHALTIC CONCRETE IN TWO LIFTS
PER FDOT STANDARD SPECIFICATION SECTION 334
FIRST LIFT: 0.75" SP 9.5 (FINE, TRAFFIC LEVEL 'TBD') BOTTOM COURSE
SECOND LIFT: 0.75" SP 9.5 (FINE, TRAFFIC LEVEL 'TBD') TOP COURSE

15" LIMEROCK BASE MATERIAL 60% MIN. CALCIUM CARBONATE
CONTENT AND FDOT STANDARD SPEC. 200 AND 911
CONSTRUCTED IN 3" (MIN.) AND 6" (MAX.) LIFTS COMPACTED TO
A DENSITY OF NOT LESS THAN 98% OF THE MAXIMUM DRY
DENSITY AS DETERMINED BY AASHTO T-180 (MIN. LBR 100)

12" STABILIZED SUB-GRADE PER FDOT STANDARD
SPECIFICATION SECTION 160 COMPACTED TO A DENSITY OF
NOT LESS THAN 98% OF THE MAXIMUM DRY DENSITY AS
DETERMINED BY AASHTO T-180 (MIN. LBR 40)

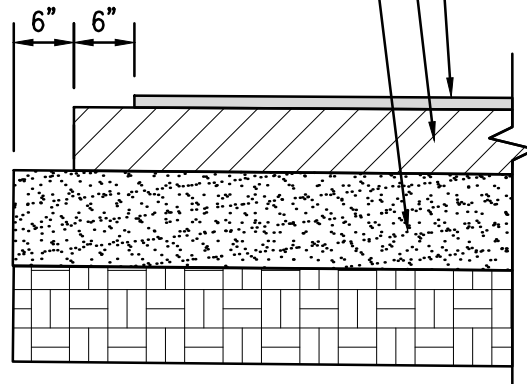

NOTES:

- TACK AND PRIME COATS ARE REQUIRED AND SHALL BE IN ACCORDANCE WITH FDOT STANDARD SPECIFICATION SECTION 300.
- ASPHALT INSTALLATION SHALL BE PERFORMED IN ACCORDANCE WITH FDOT STANDARD SPECIFICATION SECTION 334.

ASPHALT ROADWAY SECTION
SCALE: N.T.S. CURRENT

DRC

PZ24-12000017

07/02/2025

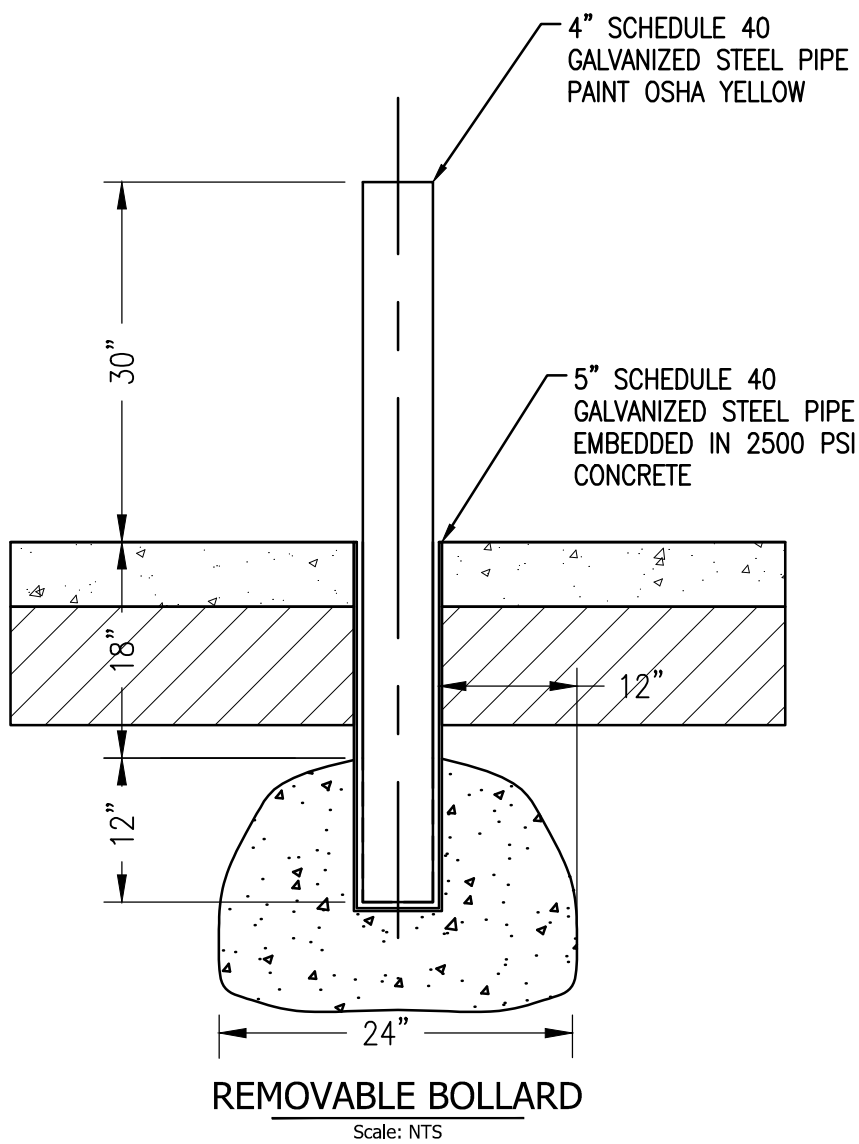

REMOVABLE BOLLARD
Scale: NTS

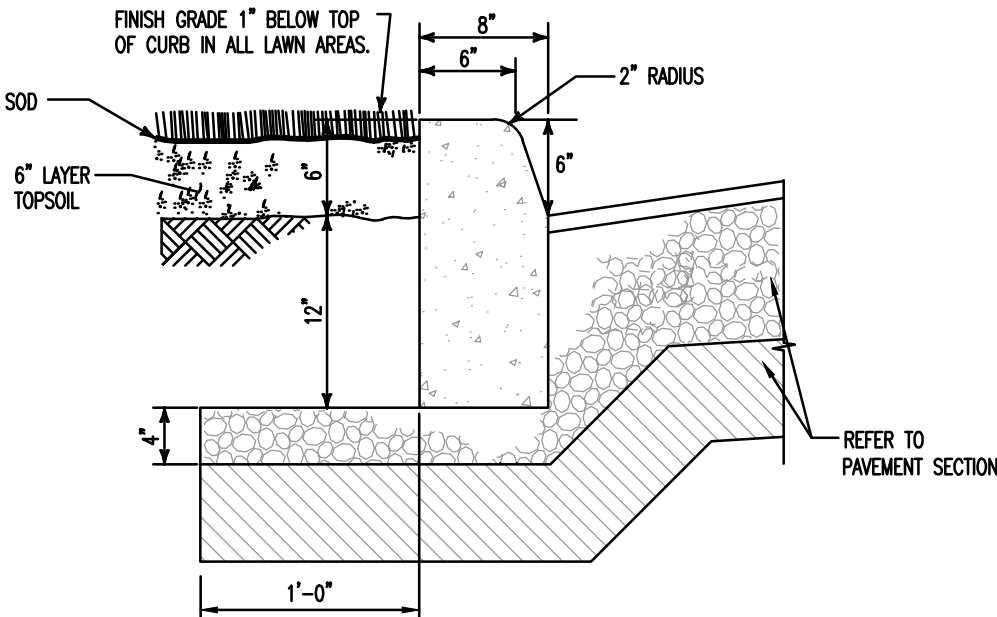

TYPE 'D' CURB DETAIL
SCALE: N.T.S. CURRENT

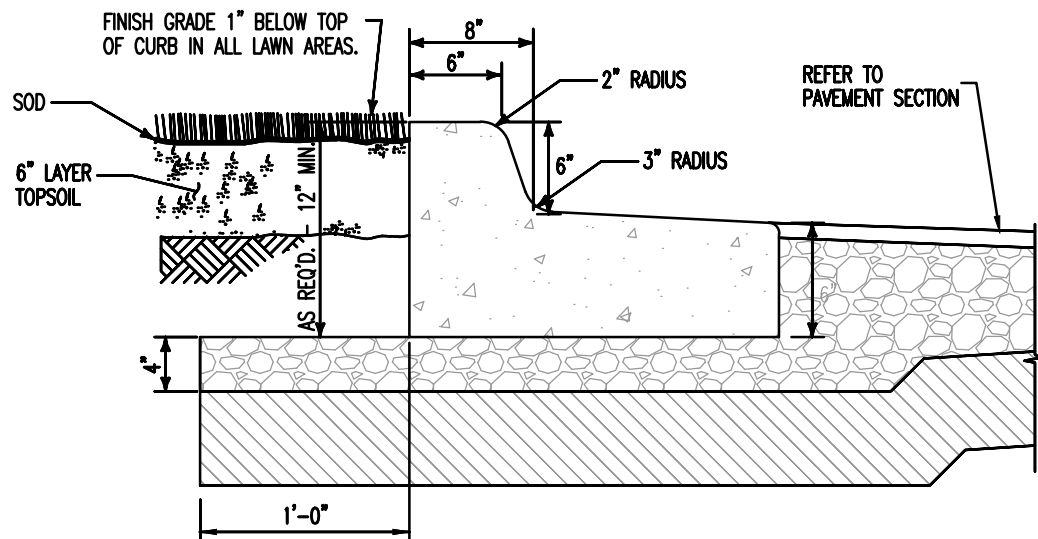

TYPE 'F' CURB DETAIL
SCALE: N.T.S. CURRENT

15" LIME ROCK BASE MATERIAL 60%
MIN. CALCIUM CARBONATE CONTENT
AND FDOT STANDARD SPEC. 200
AND 911 COMPACTED TO A DENSITY
OF NOT LESS THAN 98% OF THE
MAXIMUM DRY DENSITY AS
DETERMINED BY AASHTO T-180
(MIN. LBR 100)

1-1/2" TYPE SP-9.5
ASPHALTIC CONCRETE IN TWO (2) 3/4"
LIFTS
PER FDOT STANDARD SPECIFICATION
SECTION 331 (2000) RECYCLED
ASPHALT (UP TO 60%) MAY BE USED IN
THE FIRST LIFT ONLY

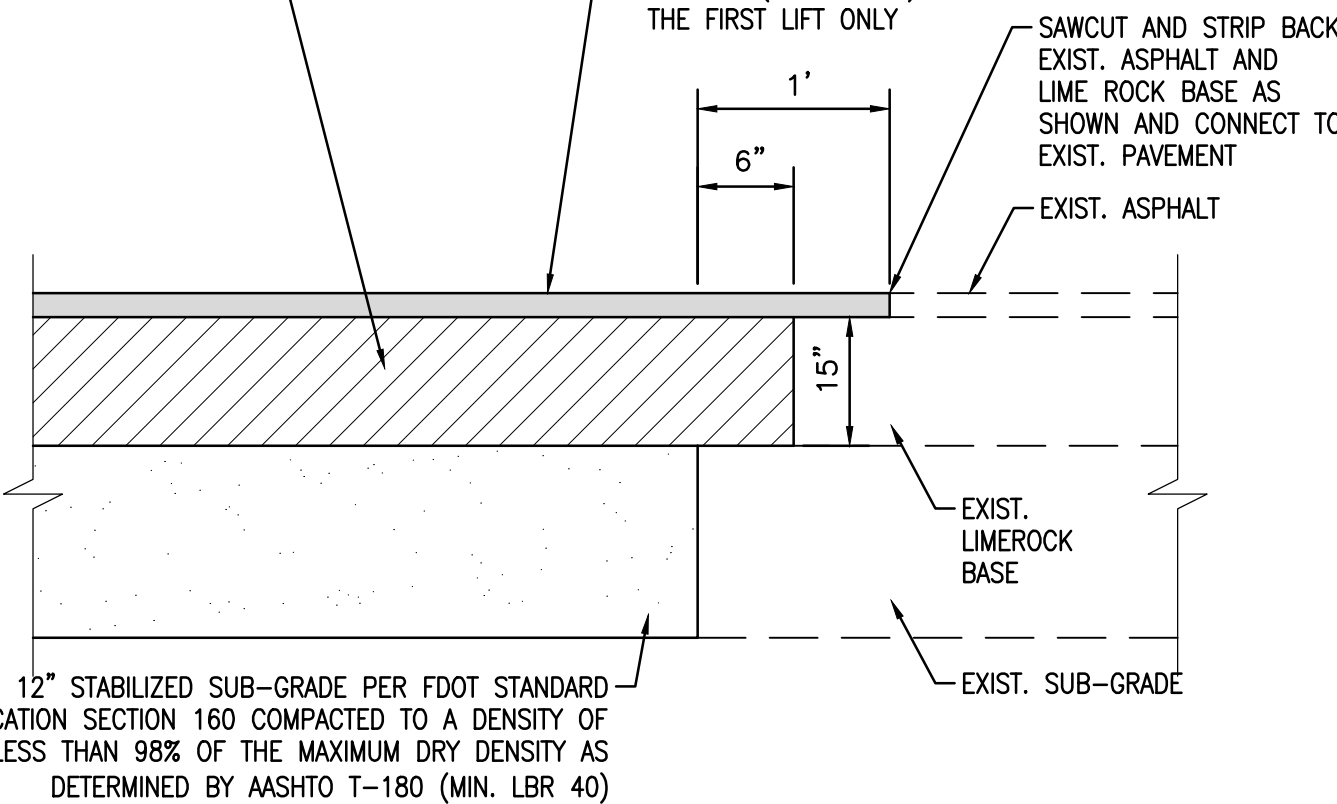

CONNECTION TO EXISTING PAVEMENT
SCALE: N.T.S.

MINOR SITE PLAN SUBMITTAL
ELEVATIONS SHOWN ARE NAVD 88



NO	DATE	REVISION	BY	NO	DATE	REVISION	BY



Calvin, Giordano & Associates, Inc.
A SAFEBUILT COMPANY
1800 Eller Drive, Suite 600, Fort Lauderdale, FL 33316
Phone: 954.921.7781 • Fax: 954.921.8807

BLOSSMAN GAS COMPANY
261 S. ANDREWS AVENUE
POMPAN0 BEACH, FL 33069

ENGINEERING DETAILS

JAMES D. MESSICK, STATE OF FLORIDA, PROFESSIONAL ENGINEER, LICENSE NO. 70870.
THIS ITEM HAS BEEN DIGITALLY SIGNED AND SEALED BY JAMES D. MESSICK DATE
INDICATED HERE.
PRINTED COPIES OF THIS DOCUMENT ARE NOT CONSIDERED SIGNED AND SEALED AND
THE SIGNATURE MUST BE VERIFIED ON ANY ELECTRONIC COPIES.
DATE: 05/09/2025

SCALE
AS SHOWN
PROJECT No
23-7806

SHEET

C2